

# **EZESEAL™**

## **MECHANICAL SPLIT SEAL**

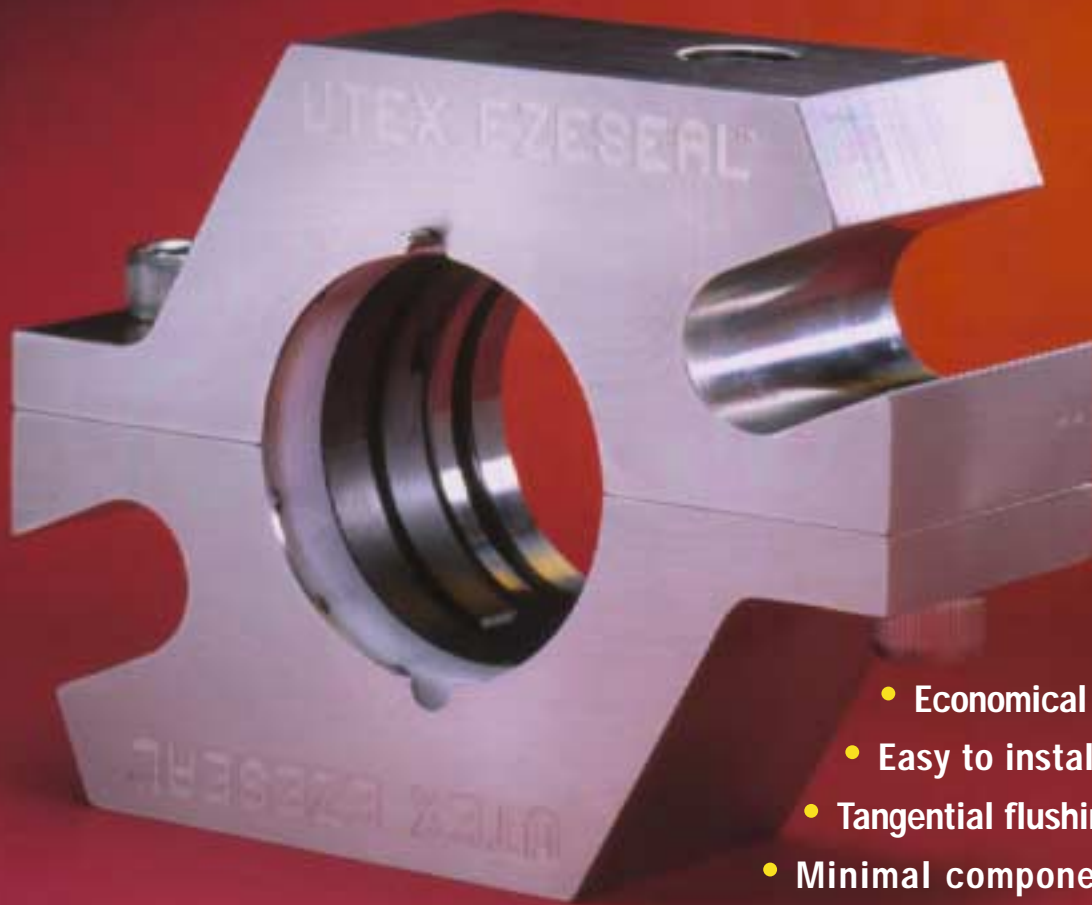

- Economical
- Easy to install
- Tangential flushing
- Minimal components
- Fits wide range of equipment



**UTEX INDUSTRIES, INC.**  
*Taking Sealing Technology Beyond Tomorrow*  
ISO 9001 Certified

## FEATURES

Carbon and Silicon Carbide  
face materials standard

Outboard springs

Stationary design

Flush ports standard

Fluorocarbon o-rings  
standard

Hastelloy™ C springs standard

Standard repair kits  
available

Minimal components

Slotted gland design

Short length

## BENEFITS

Select best material for each  
application

Non-clogging

Self-aligning

No additional cost

Better chemical and  
temperature tolerance range

Corrosion resistant

Increased field maintenance  
flexibility

Ease of installation

Fits wide range of bolt circles

Fits wide range of equipment

## SPECIFICATIONS

### Metal Components

Type 316 Stainless Steel  
Other Alloys available

### Springs

Hastelloy™ C springs

### Seal Faces

Carbon vs. Reaction Bonded Silicon Carbide  
Reaction Bonded Silicon Carbide vs.  
Reaction Bonded Silicon Carbide

### Elastomers

Fluorocarbon o-rings & gaskets standard  
Ethylene Propylene also available

### Temperature

250°F / 121°C maximum

### Shaft Speed

Up to 2 1/2" / 63.5mm = 3600 RPM  
Greater than 2 1/2" / 63.5mm = 1800 RPM

### Pressure

Up to 2 1/2" / 63.5mm = vacuum to 400 psi / 27.6 bar  
Greater than 2 1/2" / 63.5mm = vacuum to 250 psi / 17.2 bar

# EZESEAL™

## MECHANICAL SPLIT SEAL



### ***RUNNING IN LESS THAN 30 MINUTES!***

The EZESEAL from Utex Industries, Inc. is a unique approach to split mechanical seal design. It provides easy installation with long lasting reliability that can be maintained at a remarkably low cost.

#### **EASY INSTALLATION**

The EZESEAL is designed for ease of installation. There are minimal components to assemble and the unique design features allow the user to install the seal in less than 30 minutes! A split face installer is provided for quick and fail safe assembly.

#### **MATERIALS**

The EZESEAL is available standard with Carbon and Reaction Bonded Silicon Carbide face materials. All metal components, except the Hastelloy™ C springs, are supplied of Type 316 Stainless Steel. Fluorocarbon o-rings are also standard, providing a wide temperature tolerance range and an even wider chemical resistance.

#### **NON-CLOGGING SPRINGS**

The springs used to maintain contact between the sealing faces are positioned out of the product. Due to this unique configuration, the outboard springs are non-clogging! This stationary spring design improves face tracking and is self-aligning.

#### **APPLICATIONS**

Pumps, Separators, Agitators, Mixers, Dryers, Blenders,  
Any rotating equipment not easily accessible

#### **INDUSTRIES SERVED**

Pulp & paper, Food processing, Waste-water treatment,  
Refineries, Power generation, Mining, Pipeline, Water  
systems, Non-hazardous petroleum/chemical

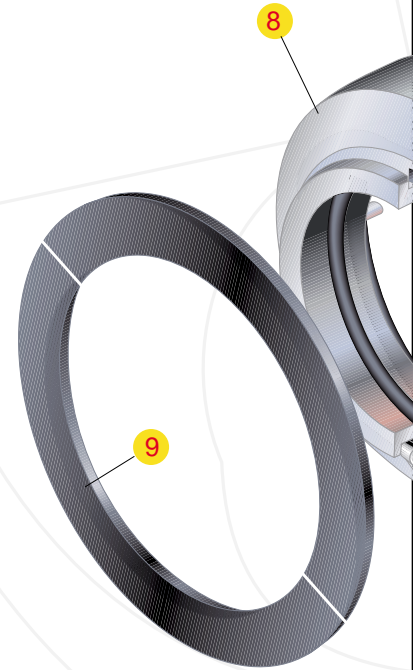

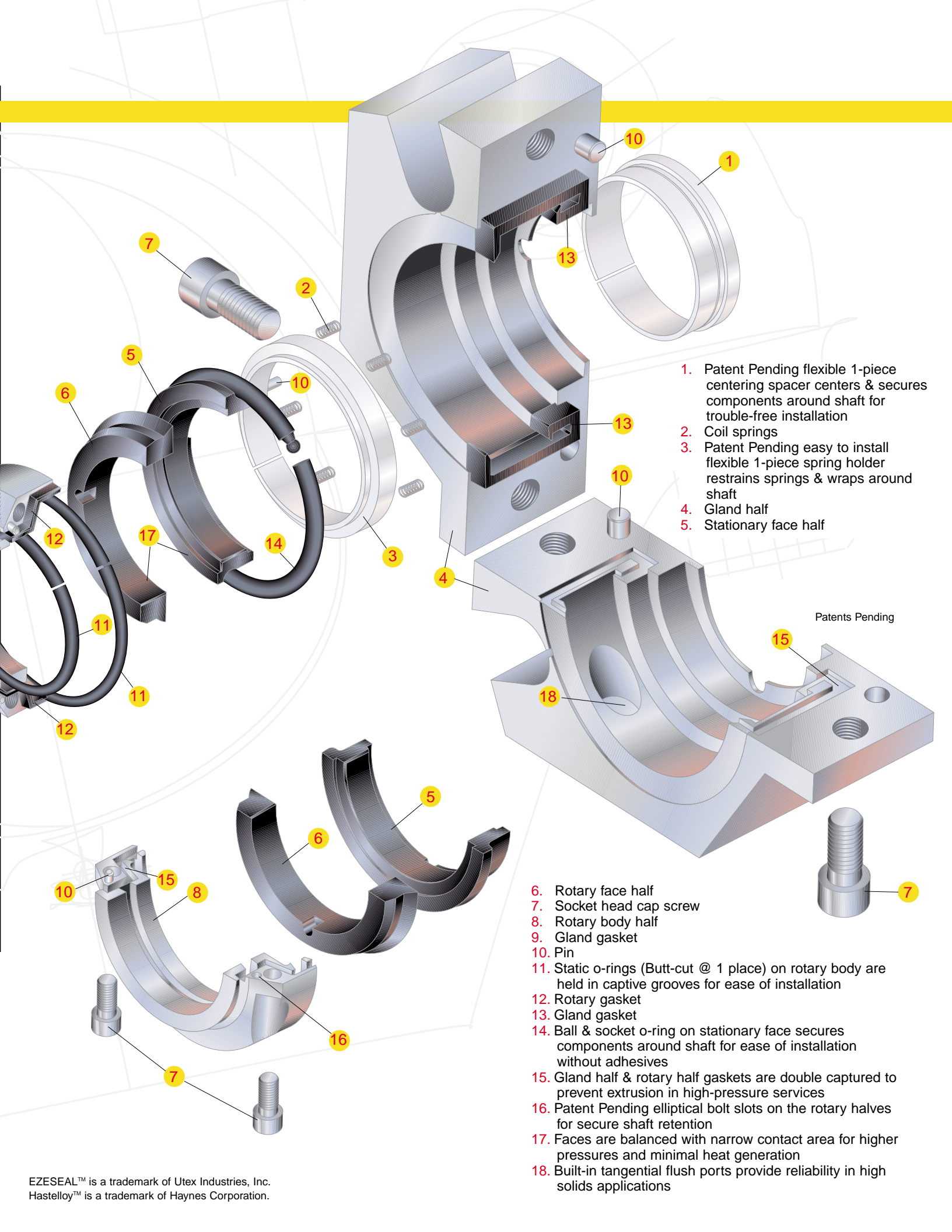

- 1. Patent Pending flexible 1-piece centering spacer centers & secures components around shaft for trouble-free installation
- 2. Coil springs
- 3. Patent Pending easy to install flexible 1-piece spring holder restrains springs & wraps around shaft
- 4. Gland half
- 5. Stationary face half

Patents Pending

- 6. Rotary face half
- 7. Socket head cap screw
- 8. Rotary body half
- 9. Gland gasket
- 10. Pin
- 11. Static o-rings (Butt-cut @ 1 place) on rotary body are held in captive grooves for ease of installation
- 12. Rotary gasket
- 13. Gland gasket
- 14. Ball & socket o-ring on stationary face secures components around shaft for ease of installation without adhesives
- 15. Gland half & rotary half gaskets are double captured to prevent extrusion in high-pressure services
- 16. Patent Pending elliptical bolt slots on the rotary halves for secure shaft retention
- 17. Faces are balanced with narrow contact area for higher pressures and minimal heat generation
- 18. Built-in tangential flush ports provide reliability in high solids applications

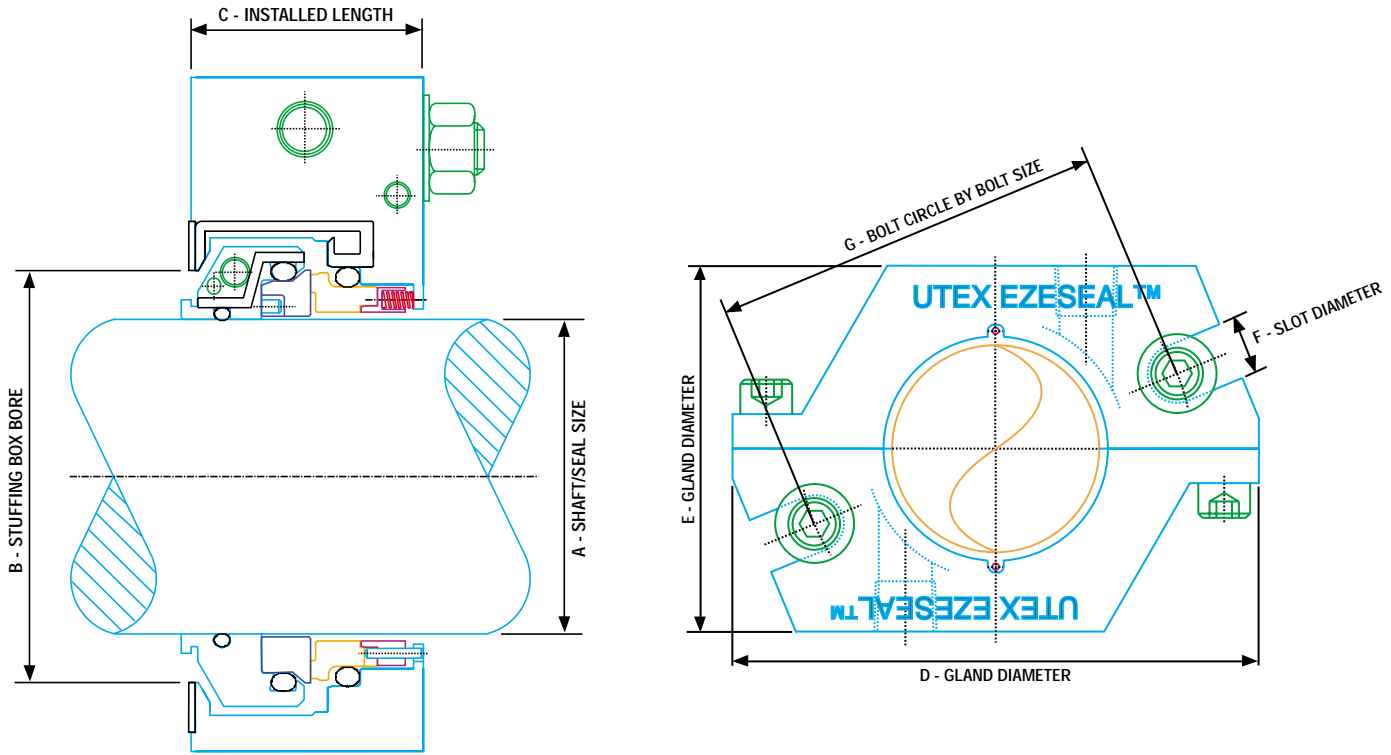

SHAFT/SEAL SIZE	STUFFING BOX BORE		STUFFING BOX BORE		INSTALLED LENGTH		GLAND DIAMETER		GLAND DIAMETER		SLOT DIAMETER		BOLT CIRCLE BY BOLT SIZE 3/8(in) 10(mm)				BOLT CIRCLE BY BOLT SIZE 1/2(in) 12(mm)				BOLT CIRCLE BY BOLT SIZE 5/8(in) 16(mm)				BOLT CIRCLE BY BOLT SIZE 3/4(in) 20(mm)				
	(in)	(mm)	MIN(in)	MIN(mm)	MAX(in)	MAX(mm)	(in)	(mm)	(in)	(mm)	(in)	(mm)	MIN(in)	MIN(mm)	MAX(in)	MAX(mm)	MIN(in)	MIN(mm)	MAX(in)	MAX(mm)	MIN(in)	MIN(mm)	MAX(in)	MAX(mm)	MIN(in)	MIN(mm)	MAX(in)	MAX(mm)	
1.250	32.0	1.750	44.5	2.250	57.2	1.78	45.2	4.78	121.4	3.62	92.0	0.81	20.6	3.13	79.4	4.38	111.1	3.25	82.6	4.25	108.0	3.38	85.7	4.13	104.8	3.50	88.9	4.00	101.6
1.375	33.0/35.0	1.875	47.6	2.375	60.3	1.78	45.2	4.91	124.6	3.75	95.3	0.81	20.6	3.25	82.6	4.50	114.3	3.38	85.7	4.38	111.1	3.50	88.9	4.25	108.0	3.63	92.1	4.13	104.8
1.500	38.0	2.000	50.8	2.500	63.5	1.78	45.2	5.03	127.8	3.88	98.5	0.81	20.6	3.38	85.7	4.63	117.5	3.50	88.9	4.50	114.3	3.63	92.1	4.38	111.1	3.75	95.3	4.25	108.0
1.625	40.0	2.125	54.0	2.625	66.7	1.78	45.2	5.16	131.0	3.88	98.5	0.81	20.6	3.50	88.9	4.75	120.7	3.63	92.1	4.63	117.5	3.75	95.3	4.50	114.3	3.88	98.4	4.38	111.1
1.750	43.0/45.0	2.250	57.2	2.750	69.9	1.78	45.2	5.28	134.1	4.00	101.6	0.81	20.6	3.63	92.1	4.88	123.8	3.75	95.3	4.75	120.7	3.88	98.4	4.63	117.5	4.00	101.6	4.50	114.3
1.875	48.0	2.375	60.3	2.875	73.0	1.78	45.2	5.41	137.3	4.00	101.6	0.81	20.6	3.75	95.3	5.00	127.0	3.88	98.4	4.88	123.8	4.00	101.6	4.75	120.7	4.13	104.8	4.63	117.5
2.000	50.0	2.500	63.5	3.000	76.2	1.78	45.2	5.53	140.5	4.12	104.7	0.81	20.6	3.88	98.4	5.13	130.2	4.00	101.6	5.00	127.0	4.13	104.8	4.88	123.8	4.25	108.0	4.75	120.7
2.125	-	2.625	66.7	3.125	79.4	1.78	45.2	5.66	143.7	4.25	108.0	0.81	20.6	4.00	101.6	5.25	133.4	4.13	104.8	5.13	130.2	4.25	108.0	5.00	127.0	4.38	111.1	4.88	123.8
2.250	55.0	2.750	69.9	3.250	82.6	1.78	45.2	5.78	146.8	4.38	111.2	0.81	20.6	4.13	104.8	5.38	136.5	4.25	108.0	5.25	133.4	4.38	111.1	5.13	130.2	4.50	114.3	5.00	127.0
2.375	60.0	2.875	73.0	3.375	85.7	1.78	45.2	5.91	150.0	4.50	114.3	0.81	20.6	4.25	108.0	5.50	139.7	4.38	111.1	5.38	136.5	4.50	114.3	5.25	133.4	4.63	117.5	5.13	130.2
2.500	-	3.000	76.2	3.500	88.9	1.78	45.2	6.03	153.2	4.62	117.4	0.81	20.6	4.38	111.1	5.63	142.9	4.50	114.3	5.50	139.7	4.63	117.5	5.38	136.5	4.75	120.7	5.25	133.4

METRIC NUMBERS ARE INDICATED IN RED

SHAFT/SEAL SIZE	STUFFING BOX BORE		STUFFING BOX BORE		INSTALLED LENGTH		GLAND DIAMETER		GLAND DIAMETER		SLOT DIAMETER		BOLT CIRCLE BY BOLT SIZE 1/2(in) 12(mm)				BOLT CIRCLE BY BOLT SIZE 5/8(in) 16(mm)				BOLT CIRCLE BY BOLT SIZE 3/4(in) 20(mm)				BOLT CIRCLE BY BOLT SIZE 7/8(in) 22(mm)				
	(in)	(mm)	MIN(in)	MIN(mm)	MAX(in)	MAX(mm)	(in)	(mm)	(in)	(mm)	(in)	(mm)	MIN(in)	MIN(mm)	MAX(in)	MAX(mm)	MIN(in)	MIN(mm)	MAX(in)	MAX(mm)	MIN(in)	MIN(mm)	MAX(in)	MAX(mm)	MIN(in)	MIN(mm)	MAX(in)	MAX(mm)	
2.625	65.0	3.125	79.4	4.125	104.8	2.22	56.4	7.75	196.9	5.12	130.1	1.00	25.4	5.38	136.5	6.88	174.6	5.50	139.7	6.75	171.5	5.63	142.9	6.63	168.3	5.75	146.1	6.50	165.1
2.750	70.0	3.250	82.6	4.250	108.0	2.22	56.4	7.75	196.9	5.12	130.1	1.00	25.4	5.38	136.5	6.88	174.6	5.50	139.7	6.75	171.5	5.63	142.9	6.63	168.3	5.75	146.1	6.50	165.1
2.875	-	3.375	85.7	4.375	111.1	2.22	56.4	7.75	196.9	5.12	130.1	1.00	25.4	5.38	136.5	6.88	174.6	5.50	139.7	6.75	171.5	5.63	142.9	6.63	168.3	5.75	146.1	6.50	165.1
3.000	75.0	3.500	88.9	4.500	114.3	2.22	56.4	7.75	196.9	5.12	130.1	1.00	25.4	5.38	136.5	6.88	174.6	5.50	139.7	6.75	171.5	5.63	142.9	6.63	168.3	5.75	146.1	6.50	165.1
3.125	-	3.625	92.1	4.625	117.5	2.22	56.4	8.25	209.6	5.62	142.8	1.00	25.4	5.88	149.2	7.56	192.1	6.00	152.4	7.44	188.9	6.13	155.6	7.31	185.7	6.25	158.8	7.19	182.5
3.250	80.0	3.750	95.3	4.750	120.7	2.22	56.4	8.25	209.6	5.62	142.8	1.00	25.4	5.88	149.2	7.56	192.1	6.00	152.4	7.44	188.9	6.13	155.6	7.31	185.7	6.25	158.8	7.19	182.5
3.375	85.0	3.875	98.4	4.875	123.8	2.22	56.4	8.25	209.6	5.62	142.8	1.00	25.4	5.88	149.2	7.56	192.1	6.00	152.4	7.44	188.9	6.13	155.6	7.31	185.7	6.25	158.8	7.19	182.5
3.500	-	4.000	101.6	5.000	127.0	2.22	56.4	8.25	209.6	5.62	142.8	1.00	25.4	5.88	149.2	7.56	192.1	6.00	152.4	7.44	188.9	6.13	155.6	7.31	185.7	6.25	158.8	7.19	182.5
3.625	90.0	4.125	104.8	5.125	130.2	2.22	56.4	8.75	223.3	6.12	155.5	1.00	25.4	6.38	161.9	8.25	209.6	6.50	165.1	8.13	206.4	6.63	168.3	8.00	203.2	6.75	171.5	7.88	200.0
3.750	95.0	4.250	108.0	5.250	133.4	2.22	56.4	8.75	223.3	6.12	155.5	1.00	25.4	6.38	161.9	8.25	209.6	6.50	165.1	8.13	206.4	6.63	168.3	8.00	203.2	6.75	171.5	7.88	200.0
3.875	-	4.375	111.1	5.375	136.5	2.22	56.4	8.75	223.3	6.12	155.5	1.00	25.4	6.38	161.9	8.25	209.6	6.50	165.1	8.13	206.4	6.63	168.3	8.00	203.2	6.75	171.5	7.88	200.0
4.000	-	4.500	114.3	5.500	139.7	2.22	56.4	8.75	223.3	6.12	155.5	1.00	25.4	6.38	161.9	8.25	209.6	6.50	165.1	8.13	206.4	6.63	168.3	8.00	203.2	6.75	171.5	7.88	200.0
4.125	-	4.625	117.5	5.625	142.9	2.22	56.4	9.25	235.0	6.62	168.2	1.00	25.4	6.88	174.6	8.75	223.3	7.00	177.8	8.63	219.1	7.13	181.0	8.50	215.9	7.25	184.2	8.38	212.7
4.250	-	4.750	120.7	5.750	146.1	2.22	56.4	9.25	235.0	6.62	168.2	1.00	25.4	6.88	174.6	8.75	223.3	7.00	177.8	8.63	219.1	7.13	181.0	8.50	215.9	7.25	184.2	8.38	212.7
4.375	110.0	4.875	123.8	5.875	149.2	2.22	56.4	9.25	235.0	6.62	168.2	1.00	25.4	6.88	174.6	8.75	223.3	7.00	177.8	8.63	219.1	7.13	181.0	8.50	215.9	7.25	184.2	8.38	212.7
4.500	115.0	5.000	127.0	6.000	152.4	2.22	56.4	9.25	235.0	6.62	168.2	1.00	25.4	6.88	174.6	8.75	223.3	7.00	177.8	8.63	219.1	7.13	181.0	8.50	215.9	7.25	184.2	8.38	212.7
4.625	-	5.125	130.2	6.125	155.6	2.22	56.4	9.75	247.7	7.12	180.9	1.00	25.4	7.38	187.3	9.25	235.0	7.50	190.5	9.13	231.8	7.63	193.7	9.00	228.6	7.75	196.9	8.88	225.4
4.750	120.0	5.250	133.4	6.250	158.8	2.22	56.4	9.75	247.7	7.12	180.9	1.00	25.4	7.38	187.3	9.25	235.0	7.50	190.5	9.13	231.8	7.63	193.7	9.00	228.6	7.75	196.9	8.88	225.4
4.875	-	5.375	136.5	6.375	161.9	2.22	56.4	9.75	247.7	7.12	180.9	1.00	25.4	7.38	187.3	9.25	235.0	7.50	190.5	9.13	231.8	7.63	193.7	9.00	228.6	7.75	196.9	8.88	225.4
5.000	-	5.500	139.7	6.500	165.1	2.22	56.4	9.75	247.7	7.12	180.9	1.00	25.4	7.38	187.3	9.25	235.0	7.50	190.5	9.13	231.8	7.63	193.7	9.00	228.6	7.75	196.9	8.88	225.4
5.125	-	5.625	142.9	6.625	168.3	2.22	56.4	10.25	260.4	7.62	193.6	1.00	25.4	7.88	200.0	9.91	251.6	8.00	203.2	9.78	248.4	8.13	206.4	9.66	245.3	8.25	209.6	9.53	242.1
5.250	-	5.750	146.1	6.750	171.5	2.22	56.4	10.25	260.4	7.62	193.6	1.00	25.4	7.88	200.0	9.91	251.6	8.00	203.2	9.78	248.4	8.13	206.4	9.66	245.3	8.25	209.6	9.53	242.1
5.375	-	5.875	149.2	6.875	174.6	2.22	56.4	10.25	260.4	7.62	193.6	1.00	25.4	7.88	200.0	9.91	251.6	8.00	203.2	9.78	248.4	8.13	206.4	9.66	245.3	8.25	209.6	9.53	242.1
5.500	-	6.000	152.4	7.000	177.8	2.22	56.4	10.25	260.4	7.62	193.6	1.00	25.4	7.88	200.0	9.91	251.6	8.00	203.2	9.78	248.4	8.13	206.4	9.66	245.3	8.25	209.6	9.53	242.1
5.625	-	6.125	155.6																										



**UTEX INDUSTRIES, INC.**

*Taking Sealing Technology Beyond Tomorrow*  
ISO 9001 Certified

**World Headquarters: 10810 Old Katy Road • Houston, Texas 77043 • 713-467-1000 • 800-359-9229**

**Houston Service Center: 5989 South Loop East • Houston, Texas 77033 • 713-649-3421 • 888-883-7579**

**Weimar: 605 Utex Drive • Weimar, Texas 78962 • 979-725-8503 • 877-469-2829**

**Odessa Service Center: 1104 Market Avenue • Odessa, Texas 79761 • 915-333-4151 • 800-873-0946**

**San Benito: 2001 Utex Drive • San Benito, Texas 78586 • 956-399-7771**

**Applied Rubber Technology, Inc.: 116-A Industrial Court • Conroe, Texas 77301 • 281-353-6321**

**AccuSeal-A Division of Utex Industries, Inc.: 1777 Upland, Suite 103 • Houston, Texas 77043 • 832-358-0350**

<http://www.utexind.com>

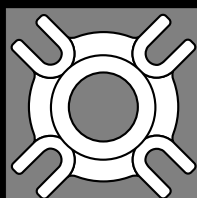

**Mechanical Seals**

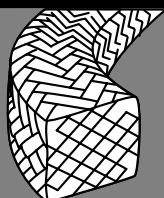

**Compression  
Packing**



**Sheet Packing**



**Packing Tools**



**Molded Products**

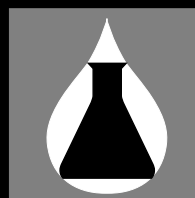

**Industrial Chemicals**